

The Centrepointe Studio is an intimate black box space which offers flexibility in its uses and configurations. The studio is ideal for intimate performances, cabaret and dinner theatre, business functions, lectures, rehearsals, master classes and workshops. It is acoustically sound and fully equipped with state-of-the-art lighting and sound systems, tension grid, a sprung floor and retractable seating.

**CONTACT INFORMATION**

<b>Address</b>		<b>Telephone</b>	
Ben Franklin Place		Administration	(613) 580-2701
101 Centrepointe Drive		Box Office	(613) 580-2700
Ottawa, ON K2G 5K7		Box Office – Toll Free	(866) 752-5231
www.centrepointetheatre.com		Production	(613) 580-2703
<b>Key Contacts</b>			
Rental Services			(613) 580-2424 x41553
Portfolio Manager		Allan Sansom	(613) 580-2424 x46653
Chief, Production Services		David Macdonell	(613) 580-2424 x41528

**UNIONS**

<b>Stage</b>		<b>Administration</b>	
International Alliance of Theatrical Stage Employees (IATSE)		Canadian Union of Public Employees (CUPE)	
		Civic Institute of Professional Personnel (CIPP)	

**GENERAL INFORMATION**

<b>Volunteers</b>
Non-Profit organizations have access to the Centrepointe Theatres Volunteer Company (CTVC) Stage Crew. In the absence of available volunteers, IATSE union staff will be hired and charged back at the applicable rates. The Licensee shall provide the Volunteer Stage Crew with appropriate meals and refreshments during the engagement at scheduled times as advanced by Centrepointe Theatres Production Services.
<b>Haze and Theatrical Smoke</b>
Productions using haze and smoke must inform Centrepointe Theatres (CT) in advance of their event. WHMIS documentation (MSDS) must be provided to CT Production Services.
<b>Pyrotechnics</b>
Productions using pyrotechnic special effects must apply for and receive a permit in accordance with City Of Ottawa bylaw services and obtain authorization from the CT, and the Fire Chief of the City of Ottawa. Operators must hold appropriate certification from the Explosive Regulatory Division of the Natural Resources of Canada.
<b>Open Flame</b>
The City of Ottawa has a No Open Flame policy.
<b>Theatrical Firearms/Weaponry</b>
All firearms, including replica firearms, must be handled in accordance with federal legislation. Advance approval required by CT Production Services.
<b>Maximum Sound Levels</b>
Sound levels are to be below 95 dB in order to be at a safe level for the patrons.
<b>Recording</b>
No video and/or audio recording is permitted without prior approval from CT. Additional IATSE fees may apply. For full details on reproduction and broadcasting, please consult the <i>General Terms and Conditions</i> .
<b>Occupational Health &amp; Safety</b>
Smoking is not permitted in Centrepointe Theatres or anywhere on City of Ottawa property. Safety footwear and hard hats as required in accordance with Ontario Ministry of Labour (MOL) regulations. Fall protection is mandatory in accordance with MOL regulations.

<b>STAGE – see attached floor plan</b>	
<b>Stage Surface</b> Masonite painted black over plywood sprung floor. Anchoring (screwing) into the floor is not permitted.	
<b>Dimensions</b> <i>Useable floor area with no seating</i> Width (middle of room): 15 m (49'-3") Depth (backdrop to retracted seating): 16.3 m (53'-5") <i>Playing Area with Standard Seating</i> Width: 12.2 m (39'-3") Depth (Setline to backdrop): 9.3 m (30'-7") <i>with OPTIONAL pit seating</i> Width: 12.2 m (39'-3") Depth (Setline to backdrop): 6.3 m (20'-7")	<b>Stage to High Transfer Area</b> <i>Door</i> 3.4 m (11'-1") Maximum width: 3.9 m (12'-11") Maximum height: <i>Rigging</i> Height (floor to Tension Grid): 6.2 m (20'-3")

<b>SEATING OPTIONS</b>
Standard Seating – 199 seats plus 4 wheelchair locations Pit Seating – 233 seats plus 4 wheelchair locations, additional production fees will apply No Seating – theatre seating retracted

<b>MASKING</b>	
<b>House Curtain (Main)</b> No house main curtain <b>Back Drop</b> - Black Velour on motorized lineset 2 – 7.3 m wide x 5.9 m high (22'-0" x 19'-4") <b>Cyclorama</b> 1 – Muslin Cloth 12.2 m wide x 5.8 m high (40'-0" x 19'-0")	<b>Border</b> - Black Velour, 0% fullness 4 – 3.7 m wide x 1.3 m high (12'-0" x 4'-3") Black velour drape on curtain track to mask off entrance area stage left, right and arcade openings on the gallery level.

<b>RIGGING</b>
<b>Tension Grid System</b> Tension Grid System is comprised of interwoven 1/8" (7x19) galvanized cables strung in tension on 2" centres and contained within a structural steel frame that is suspended from hanger points below the studio's structural steel. The tension grid is over the entire floor area of the studio. Lighting pipes are above the tension grid to allow for greater flexibility and ease of focus.
Any production that requires rigging from structural steel must advance with CT Production Services. No rigging from tension grid frame.

<b>AUDIO</b>	
Installed mix position in centre of studio control booth. Windows in control booth do open.	
<b>FOH PA</b> 4 – Meyer UPQ-1P (2/side flown) 2 – Meyer 500HP Sub (flown centre) 1 – Meyer Galileo408 processor for control  <b>Monitors</b> 8 – EAW MW12 MicroWedge 4 – Crown iTech 5000HD Amplifiers – 4 mixes 2 – JBL LSR2328P (mounted in Control Room) 3 – Yamaha MS101III for Booth Program Sound	<b>FOH Console, Processing &amp; Playback</b> 1 – Yamaha M7CL-48 v3 (48 mono + 4 stereo)  2 – Denon DN-C620 Single Pro CD Player 1 – Tascam CD-200i CD Player / ipod dock 1 – Tascam MD-02B Minidisk Player  <b>Patching</b> All house patch points terminate to bantam patchbays in Control Booth.

<b>Microphones and DIs</b> 6 – Shure SM58 5 – Shure SM57 1 – Shure Beta 52A 3 – Shure SM81 2 – AKG 414 3 – Sennheiser e904 with drum clip 3 – Crown PCC 160 2 – Countryman 4-C-18 podium mic 6 – Radial JDI Passive DI box 1 – Whirlwind PCDI  <b>Wireless</b> 2 – Shure UHF-R UR4D Dual Receiver (H4 Band 518-578 MHz) 4 – Shure UR2/SM58 wireless handheld 4 – Shure UR1 wireless body pack transmitters 4 – Countryman E6i earsets	<b>Stands</b> 12 – K&M 210/9 Tall mic stand with boom 12 – K&M 259/1 Short mic stand with boom 8 – table top mic stands  <b>Intercom System</b> <b>WIRELESS</b> 1 – Clearcom Tempest 2400 CM-222 base station 5 – Clearcom Tempest CP-222 belt packs  <b>WIRED</b> 1 – Clearcom MS702 station (booth SM position) 1 – Clearcom RM702 station (booth audio position) 1 – Clearcom KB702 station (booth lighting position) 4 – Clearcom RS-601 belt packs (1 channel) 10 – Clearcom CC-95 headsets (single muff)  <b>Assistive Listening System</b> Brahler MSI-8d IR Transmitter with IR Radiator
---------------------------------------------------------------------------------------------------------------------------------------------------------------------------------------------------------------------------------------------------------------------------------------------------------------------------------------------------------------------------------------------------------------------------------------------------------------------------------------	--------------------------------------------------------------------------------------------------------------------------------------------------------------------------------------------------------------------------------------------------------------------------------------------------------------------------------------------------------------------------------------------------------------------------------------------------------------------------------------------------------------------------------------------------------------------------------------------------------------------------------------------------------

<b>PRODUCTION POWER SOURCE</b>		
	<b>Lighting</b>	<b>Audio</b>
LOCATION:	Grid Level-upstage right	4 x SL & 4 x SR on upstage wall
CAPACITY:	400 Amp	20 Amp
PHASES:	3∅	1∅
VOLTAGE:	120/208 volt, 60 Hz, 5 wire	120 volt, 60 Hz
CONNECTORS:	Cam-Loc E1016 Female	Edison U-Ground

**LIGHTING** – see <http://centrepointheatre.com/en/rentals/studio/index.htm> for LX plot

The Studio is equipped with a pre-hung and coloured stock lighting plot.  
The stock lighting plot must be restored at the production’s expense if any changes are made.  
House light control from booth or stage right.

<p><b>Console</b> 1 – ETC ION 1000 with 2 x 20 Fader Wings and wireless NET3RFR remote</p> <p><b>Dimmers</b> 2 – ETC Sensor+ 96 channel racks All wired dimmer per circuit (2.4kW)</p> <p><b>Circuits</b> 186 – 20A (Mix of L5 Twistlock &amp; Socapex)</p> <p><b>Control Protocol :</b> ETC sACN/eDMX Network Additional Gateways available.</p>	<p><b>Followspots</b> 2 – LDR Canto – 1k</p> <p><b>Mirror Ball</b> 1 – 20” mirror ball with 1 RPM motor</p> <p><b>Subject to availability</b> (shared with theatre):</p> <p><b>Hazer</b> 2 – Ultratec Radiance Hazer with fan</p> <p><b>Fogger</b> 2 – Martin Jem ZR44</p>
-----------------------------------------------------------------------------------------------------------------------------------------------------------------------------------------------------------------------------------------------------------------------------------------------------------------------------------------------------------------------------------	--------------------------------------------------------------------------------------------------------------------------------------------------------------------------------------------------------------------------------------------------------------------------------------------

**Fixture Inventory**

Type	Total Inventory	Used in Stock Plot	Available
ETC Source Four - 19°	12	8	4
ETC Source Four - 26°	27	25	2
ETC Source Four - 36°	23	22	1
ETC Source Four - 50°	10	8	2
ETC Source Four - 15-30° Zoom	4	4	0
ETC Source Four - 25-50° Zoom	10	4	6
ETC Source Four – Par Medium	25	10	15
ETC Source Four – Parnel	35	31	4
ChromaQ CF12 LED RGBA	12	6	6*
Altman Cyc - 3 CELL	4	4	0
Martin MAC250 entour	4	4	0
	<b>161</b>	<b>127</b>	<b>34</b>

\* subject to availability

**VIDEO**

**Projector**

- 1 – Panasonic PT-DZ6710U HD 6000 lumen DPL  
Stock Lens installed: ET-DLE350 3.6 - 5.4:1

**Projection Screen – flown upstage centre when required.**

- 1 – Draper Cinefold 4.26 m x 3.05 m (14'-0" x 10'-0") with Fast Fold flyable truss frame.  
4:3 ratio, Uniflex front projection surface

**Switching**

- 1 – Extron Video Matrix Switching System (Analog RGB)

**Playback**

- 1 – Tascam BD-R2000 Blu-ray player

Users must provide laptop if required for playback/presentations.

**Shared Equipment between Mainstage & Studio**

The following equipment is shared between Centrepointe Mainstage and the Studio Theatre. Please inquire about availability with Production Services during show advance.

**Pianos (A=440)**

- 9' Yamaha CFIII Concert Grand Piano
- 6' Yamaha GS6 Grand Piano

**Orchestra**

- 70 – Black Orchestra Chairs (padded, no arms)
- 45 – Black Music Stands
- 40 – Music Stand Lights
- 1 – Conductor Music Stand
- 1 – Conductor Podium 0.9m x 0.9m (3'x3')

**Audio Equipment**

- 1 – Whirlwind PressPower2 Media Box
- 3 – Yamaha MS202II Monitor Speakers
- 4 – QSC K8 Powered Speakers

**Podium**

- 2 – Wood Podium

**Pipe & Drape kit**

**Risers**

- Black plywood lids on folding bases
- 5 – 1.2m x 2.4m x 0.15m (4' x 8' x 6")
- 2 – 1.2m x 2.4m x 0.41m (4' x 8' x 16")
- 5 – 1.2m x 2.4m x 0.46m (4' x 8' x 18")
- 5 – 1.2m x 2.4m x 0.76m (4' x 8' x 30")

**Dance Floor**

- Rosco Reversible Black / Gray
- 5 Rolls – 1.6 m (5¼') x 12 m (40')
- 60 – Black Masonite 1.2m x 2.4m (4' x 8') sheet

**Other Furniture**

- 4 – Metal Stools ~ 28" high
- 3 – Black Tables 6' x 2'-6"
- 2 – Black Tables 6' x 1'-6"

**BACKSTAGE** – floor plans available upon request

**Stage Door** – North side of Ben Franklin Place (See attached map)

All cast and crew are required to enter here and check in with Stage Door Attendant

**Greenroom** – one floor up from stage level

Chairs and Tables. Stove, Coffee maker, Microwave, Fridge, Ice Machine

**Servery** – stage right hallway

Sink, Microwave & Fridge

**Dressing Rooms** – stage right hallway

2 – Large dressing rooms with dressing tables, mirrors, clothing racks. 13 stations per room.

Private shower, toilet and sinks in each dressing room.

**Wardrobe Room** – end of dressing room hallway

One high efficiency (HE) washing machine and one dryer. Ironing boards and steamer available.

**Loading Docks** (shared with mainstage space)

2 – Indoor truck level docks. Can accommodate vehicles up to 22.8m (75') in length.

14 m (46') push to Stage Left. All shows must load-in through the LOADING DOCK.

Interior Loading Doors: Max. Height 2.7 m (8' 10") Max. Width 2.4 m (7' 10")

**Parking**

There is free parking in the main lot of Ben Franklin Place.

Parking is not permitted along the loading dock access ramp. Dock access must remain clear.

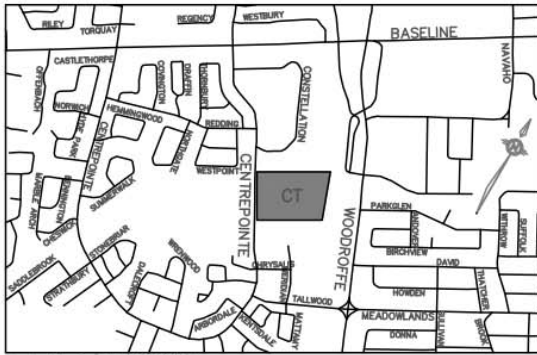

MAP NOT TO SCALE

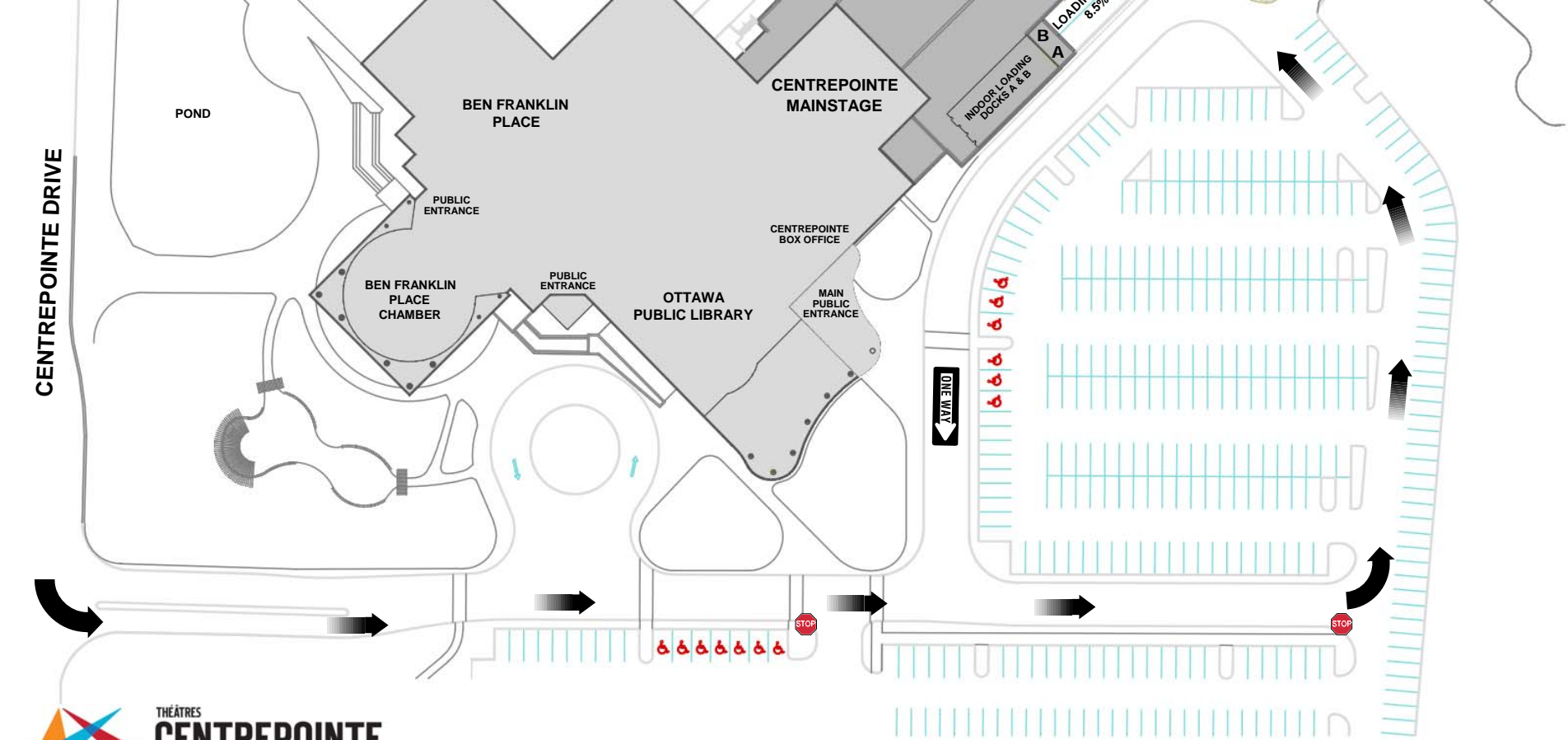

**Ben Franklin Place - 101 Centrepointe Drive**  
 Ottawa, ON K2G 5K7  
 613-580-2703 - Production/Stage Door  
 Google Map Link: <http://g.co/maps/km5vn>

**ALL CAST AND CREW TO ENTER BY  
 STAGE DOOR ENTRANCE**

**Follow arrows to access the theatre loading docks  
 for theatre deliveries and pickups.**

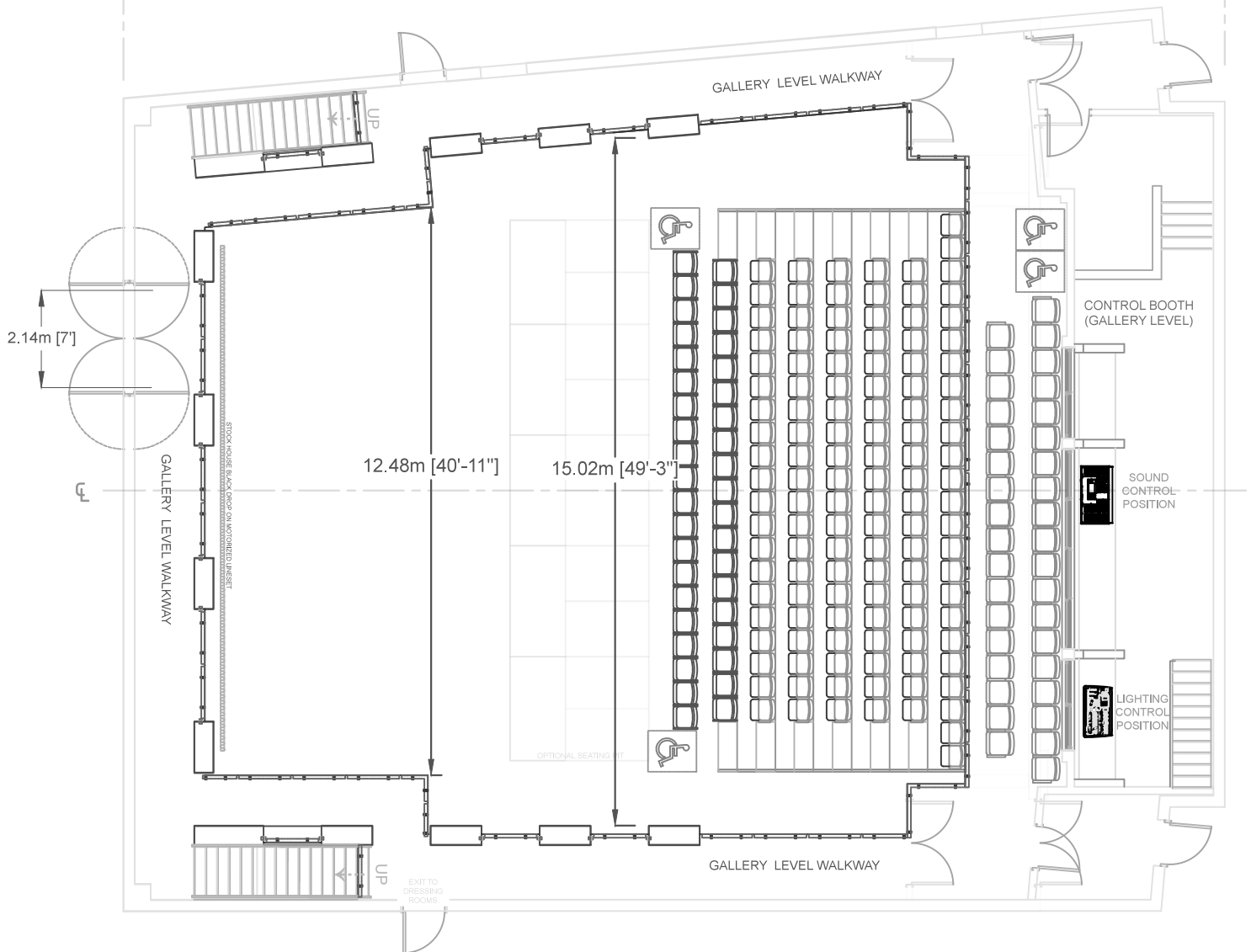
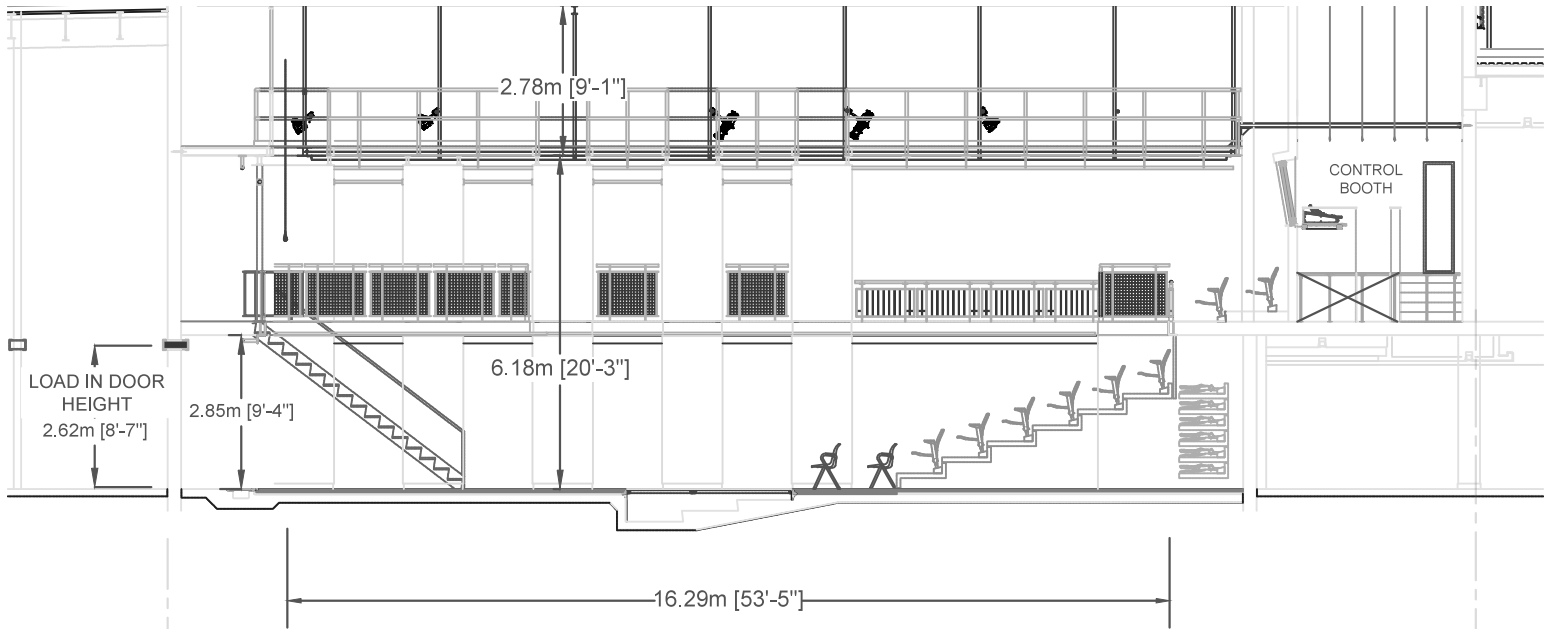

Studio du Théâtre Centrepointe Studio Theatre  
 Plan & Section View, Voir plan et coupe  
 Configuration standard configuration

199 seats & 4 wheelchair locations 199 sièges et 4 places pour fauteuil roulant

